



# PEB

Compendium of exemplary  
educational facilities 3<sup>rd</sup> Edition



OECD



# PEB

## Compendium of exemplary educational facilities

3<sup>rd</sup> edition

## ADVERTISEMENT

OUR COMMITMENT IS TO SUBSTANTIALLY ENHANCE THE LIVES OF PEOPLE WHO LIVE, LEARN AND WORK WITHIN THE COMMUNITIES WE CREATE.

IT IS THROUGH OUR COMMITMENT TO OUR CORE VALUES OF RESPECT, INTEGRITY, INNOVATION, COLLABORATION AND PURSUIT OF EXCELLENCE THAT LEND LEASE COMMUNITIES CLAIM NATIONAL AND GLOBAL PRE-EMINENCE FOR WHAT WE DO - AND THAT IS CREATING SPECIAL PLACES AROUND THE WORLD.

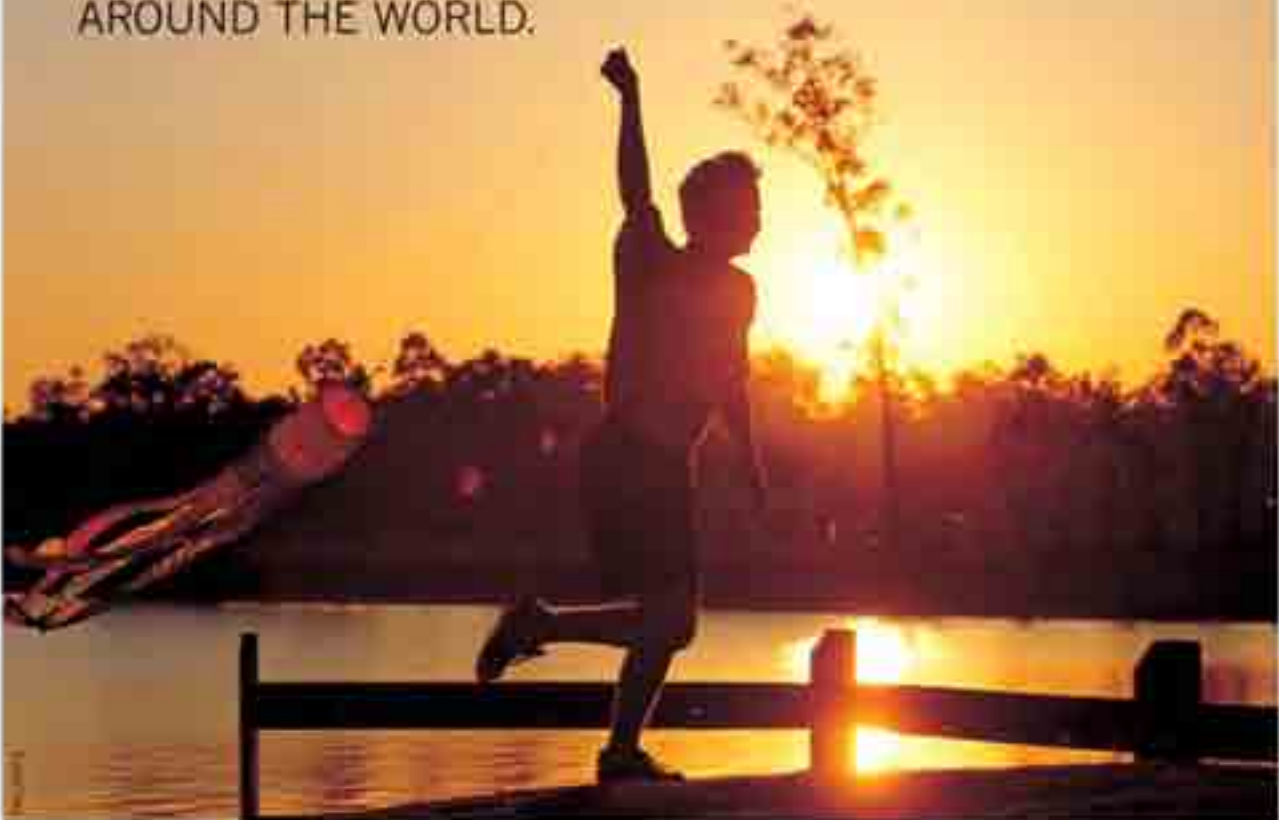

IT'S WHAT WE BELIEVE, IT'S WHAT WE DO.



[www.lendlease.com/usa](http://www.lendlease.com/usa)

## ORGANISATION FOR ECONOMIC CO-OPERATION AND DEVELOPMENT

The OECD is a unique forum where the governments of 30 democracies work together to address the economic, social and environmental challenges of globalisation. The OECD is also at the forefront of efforts to understand and to help governments respond to new developments and concerns, such as corporate governance, the information economy and the challenges of an ageing population. The Organisation provides a setting where governments can compare policy experiences, seek answers to common problems, identify good practice and work to co-ordinate domestic and international policies.

The OECD member countries are: Australia, Austria, Belgium, Canada, the Czech Republic, Denmark, Finland, France, Germany, Greece, Hungary, Iceland, Ireland, Italy, Japan, Korea, Luxembourg, Mexico, the Netherlands, New Zealand, Norway, Poland, Portugal, the Slovak Republic, Spain, Sweden, Switzerland, Turkey, the United Kingdom and the United States. The Commission of the European Communities takes part in the work of the OECD.

OECD Publishing disseminates widely the results of the Organisation's statistics gathering and research on economic, social and environmental issues, as well as the conventions, guidelines and standards agreed by its members.

This work is published on the responsibility of the Secretary-General of the OECD. The opinions expressed and arguments employed herein do not necessarily reflect the official views of the Organisation or of the governments of its member countries.

Also available in French under the title:  
*Florilège d'établissements d'enseignement exemplaires  
du PEB : 3<sup>e</sup> Édition*

© OECD 2006

No reproduction, copy, transmission or translation of this publication may be made without written permission. Applications should be sent to OECD Publishing: [rights@oecd.org](mailto:rights@oecd.org) or by fax (+33-1) 45 24 13 91. Permission to photocopy a portion of this work should be addressed to the Centre Français d'exploitation du droit de Copie, 20 rue des Grands-Augustins, 75006 Paris, France ([contact@cfcopies.com](mailto:contact@cfcopies.com)).

# Groupe Scolaire Martin Peller

Reims, France

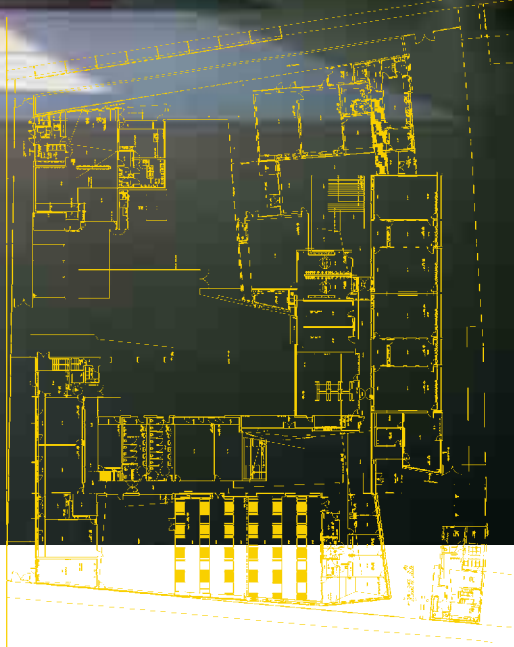
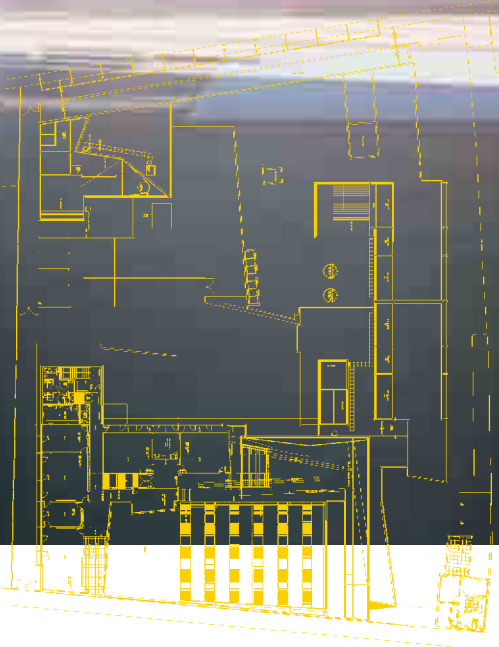
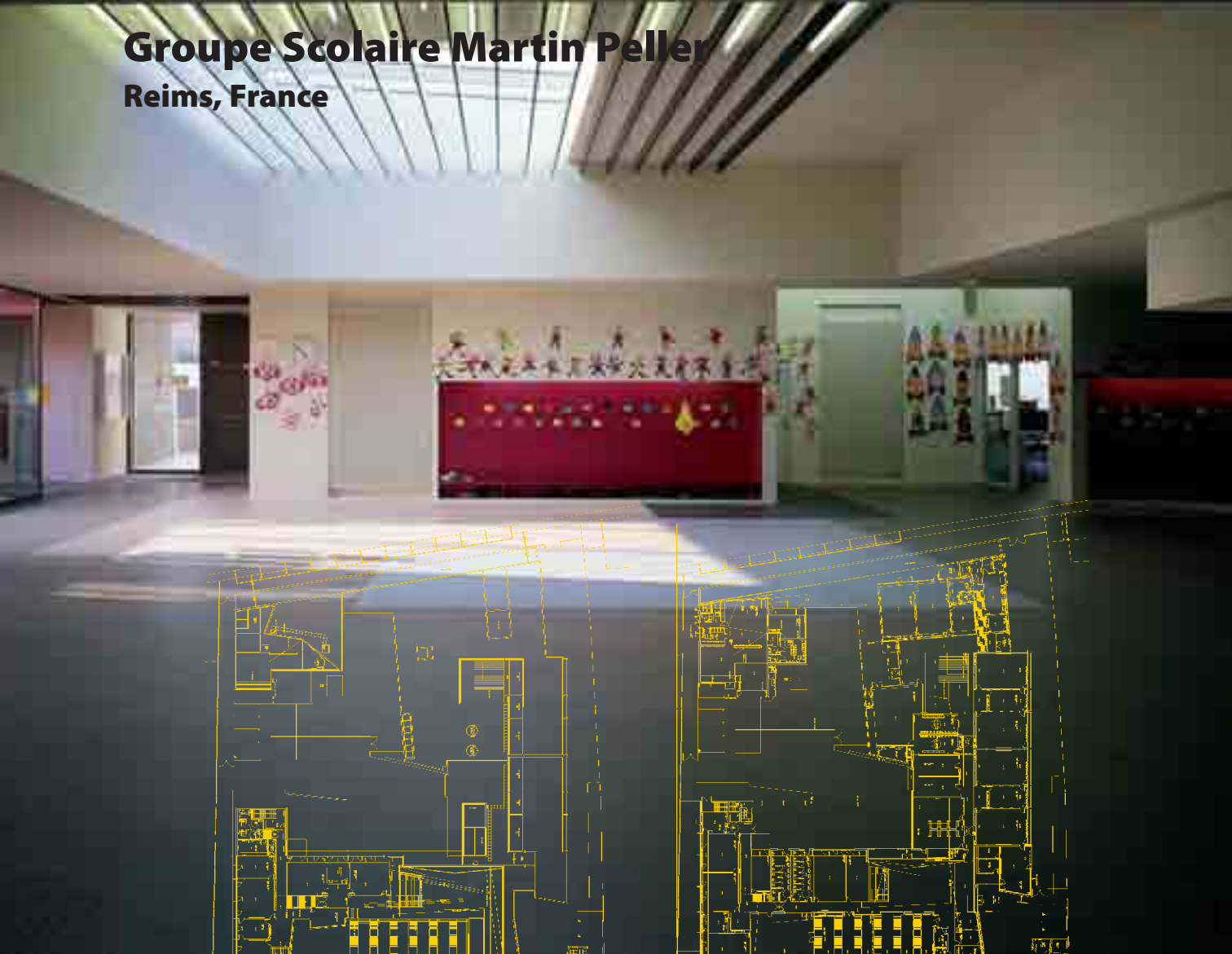

## Groupe Scolaire Martin Peller Reims, France

### Criteria

Flexibility / Community

### Architect

Dominique Coulon

### Type of School

Pre-primary and primary

### No. of Students

274

### Type of Project

New building

### Gross Surface Area

5 244 m<sup>2</sup>

### Year of Completion

2004

### Client

City of Reims

**A** bold and modern design concept with bright colours and interesting shapes, the Martin Peller School offers an innovative educational programme within a distinctive structure in a traditional urban setting.

### Fully equipped and accessible facilities

The facility includes classrooms, a dormitory, physical education hall, multipurpose room, multimedia room, audio-visual room, reception areas, a staff room, libraries, playgrounds, a refectory and kitchenettes. The physical layout is designed around two levels of education – pre-primary and primary – or “*cycles*”, with some joint nursery/elementary functions. All elementary classrooms are wired for and equipped with computers, and a computer/multimedia room is shared with nursery pupils. The facility is accessible and open to families, pupils and local residents outside school hours. All facilities are accessible to people with reduced mobility.

### Functional planning and a programme that reflects key goals

The programme and building design were based on new programme guidelines for levels of education, new teaching practices, and the facilities required for learning and physical/sporting/cultural activities. These guidelines led to the project’s key features, namely:

- The layout of classrooms, storage units and water supply, with adjacent handicraft/cultural rooms for joint activities.
- Motor skills and sports/physical activities with a large, flexible space for sports, music and movement activities (shared by elementary and nursery pupils), and a physical education room.
- ICT wiring and equipment throughout the school.
- Shared-use areas available to both the elementary and nursery schools, such as a dedicated eating space.
- Teachers working in teams.
- Areas to meet the demand for outdoor space, in particular for gardening activities and of course playgrounds with the necessary play facilities.





## PEB Compendium of Exemplary Educational Facilities: 3<sup>rd</sup> Edition

The 3<sup>rd</sup> PEB Compendium features educational institutions from 20 countries selected by an international jury for their exemplary facilities. This work addresses how the design, use and management of physical infrastructure can contribute to the quality of education. With full-colour photographs, plans and descriptions, the Compendium focuses on the functionality of 65 recently completed or refurbished buildings or grounds, chosen for their innovation in the areas of safety, sustainability, alternative financing, community and flexibility. In addition to schools and universities, this third edition of the PEB Compendium covers pre-schools and gives special attention to how effectively the facilities meet the needs of their users: students, teachers, parents and the community at large.

[www.oecd.org/edu/facilities/compendium](http://www.oecd.org/edu/facilities/compendium).

ISBN: 92-64-02229-5



[www.oecd.org](http://www.oecd.org)