

Project

Moulon School Group in Gif-sur-Yvette



Architect

Dominique Coulon
& associés

Structural Engineer

Batiserf Ingénierie

Address

Allée de l'école
91190 Gif-sur-Yvette
France

Client

Établissement Public
Paris Saclay

Kind of school

Nursery school, elementary
school, leisure center, gym-
nasium, and catering school

Completion

2021

Size

7,400 m²

Ages

3–10

Sustainable features

Certified positive energy
building, photovoltaic
panels

The Moulon School Group in Gif-sur-Yvette was designed based on an existing urban renewal master plan. The complex opens to the west, and buildings on the other three sides form a protective enclosure around the play-grounds. The different entrances for the nurs-ery school, primary school, and recreation area are positioned along Moulon's pedestrian route, creating a strong connection between the school group and the public space. The neighborhood where the school group is locat-ed comprises buildings that are very light-col-ored – mainly white and pale gray – with a square design. The project affirms its status as a public facility by contrasting with this con-text through its use of color and diagonals. The idea was to move away from an orthogo-nal system. The nursery school and its play-ground, the after-school reception area, the cafeteria, and the sports hall are all on the ground floor. The primary school occupies the two floors above. Its playground is on the roof, providing clearly differentiated spaces for the children in both schools.



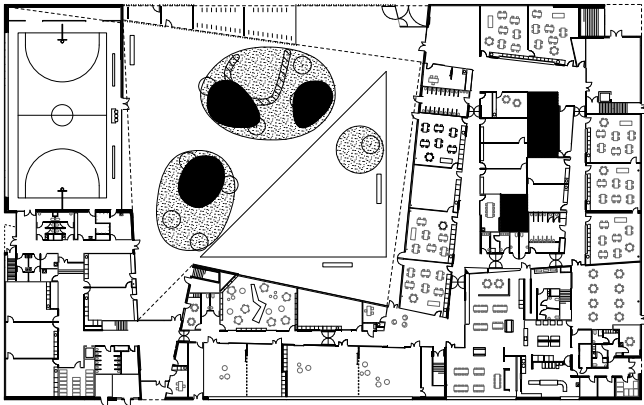

b

- a Elementary school entrance forecourt
- b Floor plan
- c Sports hall
- d Kindergarten reception hall
- e Elementary school hallway
- f Elementary school staircase
- g Green patio



c d



e f



g